

PL1241

NO.	DESCRIPTION	NO.	DESCRIPTION
1	NYLON CLIP	26	WASHER $\Phi 8 \times \Phi 16 \times 1.6$
2	FRONT AXLE CLAMP PLATE	27	BOLT M8*45
3	SCREW M6*12	28	SNAP RING
4	WHEEL COVER	29	REAR COVER SHAFT
5	FRONT WHEEL	30	BOLT M6*8
6	NUT M8	31	ENGINE
7	FRONT WHEEL SHAFT ASSEMBLY	32	BOLT M8*16
8	INCH BOLT 3/8-24x39	33	BOLT M8*25
9	DISHED WASHER	34	DECK PAD
10	BLADE	35	TORSION SPRING
11	HEIGHT ADJUSTMENT SPRING	36	REAR COVER
12	NUT M6	37	RIGHT BRACKET
13	ADJUSTABLE CONNECTING ROD	38	LOWER PUSH ROD PLUG
14	SCREWS T6x12	39	BRAKE CABLE
15	KNIFE HOLDER	40	CABLE SUPPORT
16	REAR WHEEL SHAFT ASSEMBLY	41	STRAW BOX SUPPORT
17	HEIGHT ADJUSTMENT HANDLE	42	FABRIC BAG
18	HANDLE	43	LOWER HANDLE
19	REAR WHEEL	44	UPPER HANDLE
20	REAR WHEEL COVER	45	DRAWSTRING HOOK
21	DECK	46	WASHER $\Phi 6 \times \Phi 12 \times 1.5$
22	FRONT FACE	47	BOLT M6*30
23	LEFT BRACKET	48	NUT M6
24	BOLT M8*16	49	BRAKE LEVER
25	NOB		

PL1241-EX-KMSK03P2024027ST

Sturmi!
нас рекомендуют друзья

ENGINE FOR PL1241, PL1446, PL1446S

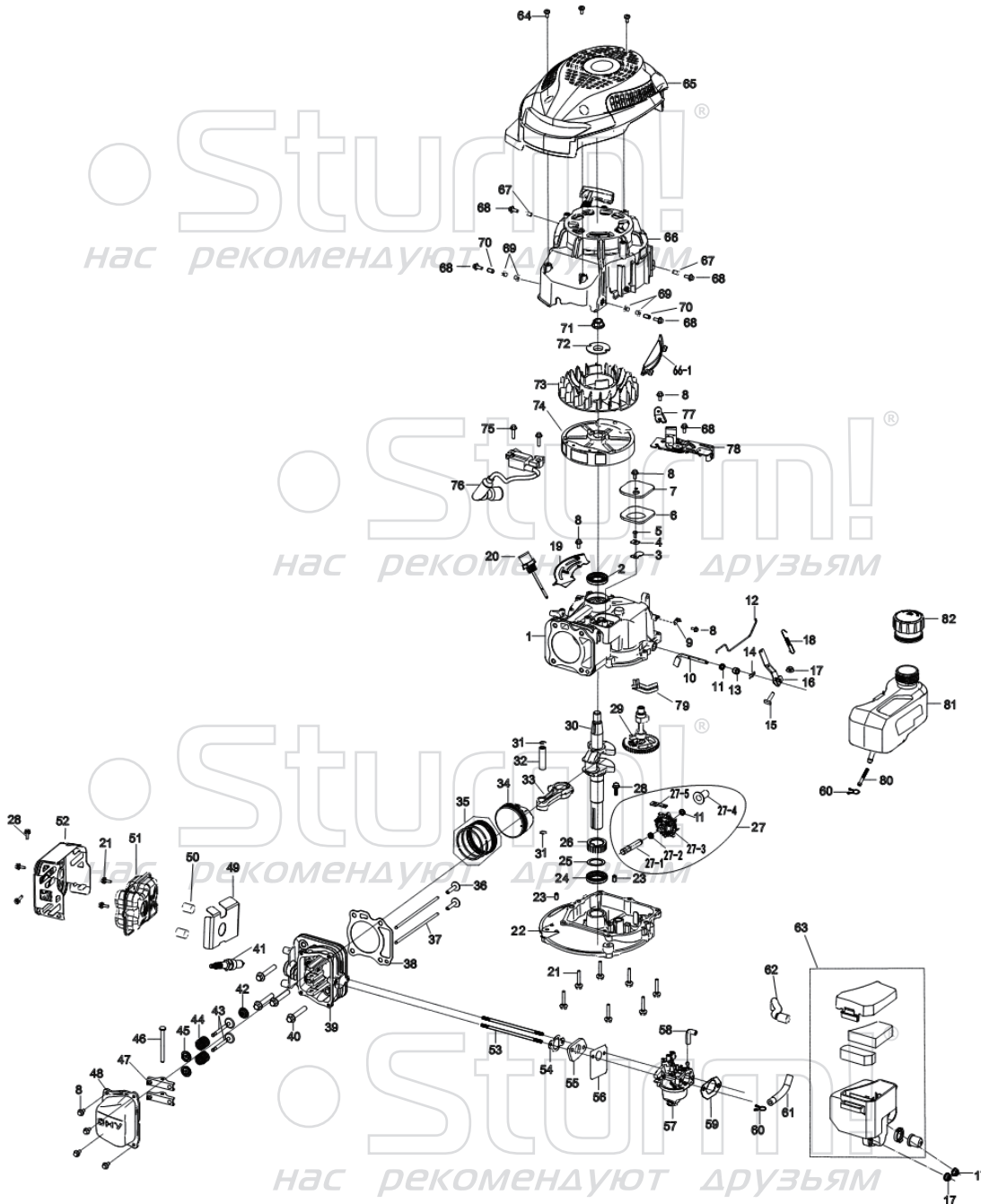

NO.	DESCRIPTION	NO.	DESCRIPTION
1	CRANKCASE	40	BOLT M8X50
2	OIL SEAL	41	SPARK PLUG
3	VALVE ELEMENT	42	OIL SEAL
4	LIMIT PLATE	43	VALVE
5	SCREW M4×6	44	SPRING
6	GASKET OF RESPIRATOR COVER	45	SPRING SEAT
7	RESPIRATOR COVER PLATE	46	SHAFT
8	BOLT M5X12	47	VALVE ROCKER ARM
9	THROTTLE CONTROL GROUP	48	CYLINDER HEAD COVER
10	SPEED REGULATOR ROCKER SPINDLE	49	GASKET OF MUFFLER
11	WASHER Φ6	50	BUSHING
12	SPEED ADJUSTMENT LEVER	51	MUFFLER ASSY
13	OIL SEAL	52	MUFFLER COVER ASSY
14	SPRINGNESS SPLIT PIN	53	DOUBLE BOLT M6×96
15	T-BOLT	54	PAPER GASKET OF INLET PIPE
16	SPEED REGULATOR ROCKER	55	HEAT INSULATION GASKET
17	NUT M6	56	PAPER GASKET
18	SPRING	57	CARBURETOR
19	BACK PLATE	58	OIL PIPE 1
20	LUBRICATING GAUGE	59	GASKET
21	BOLT M6X30	60	OIL PIPE CIRCLIP
22	CRANKCASE COVER	61	OIL PIPE 2
23	PIN Φ8×12	62	EXHAUST PIPE
24	OIL SEAL	63	AIR FILTER
25	WASHER Φ25.5×Φ34.5×1	64	SCREW ST5×15
26	GEAR	65	ENGINE HOOD ASSEMBLY
27	RATE-LIMITING GEAR ASSY	66	HAND STARTING ASSEMBLY
27-1	GEAR SHAFT	66-1	WIND DEFLECTOR
27-2	WASHER Φ6	67	BUSHING 1
27-3	RATE-LIMITING GEAR	68	BOLT M5X20
27-4	SLIDING SLEEVE	69	BUSHING 2
27-5	PRESSURE PLATE	70	BUSHING 3
28	BOLT M6X12	71	NUT M14X1.5
29	CAM ASSY	72	STARTER CUP BASE
30	CRANKSHAFT	73	FAN
31	SPRING	74	FLYWHEEL ASSEMBLY
32	PISTON PIN	75	BOLT M5X25
33	CONNECTING ROD ASSY	76	IGNITION
34	PISTON	77	HOOD SUPPORT LUGS
35	PISTON RING ASSY	78	BRAKE ASSY
36	TAPPET	79	OIL RETURN BLOCK
37	GUIDE BOARD OF HANDSPIKE	80	OUTLET NOZZLE STRAINER
38	SEAL GASKET	81	TANK
39	CYLINDER HEAD ASSY	82	FUEL TANK CAP

PL1241/PL1446/PL1446S-EX-KMSK03P2024027ST